



yojan  
one  
APPRECIATE TIME

A Project by MERU REALTY

*In today's life  
luxury is "Time & Space"*

-Harmon Ohinto



Imagination

is a genesis of dreams.  
They are the vision of our  
minds eye. Creativity and  
Insight give shape to our  
vision and make them  
tangible. Fulfillment of your  
dreams is an exhilarating  
duty, we take pride in.

At Yojan One,

Imagine The Best.





# Welcome Smiles

A location so convenient, a project so viable, a home so cozy. A life so secure, peaceful and comfortable; everything so perfect.

The PROMISE OF A LIFESTYLE that is at the very HEART OF THE CITY. A life so full of cheer, it will put a smile on everyone's face.



ENTERTAINMENT

# Welcome **O**pportunities

When your home is at an EPICENTER, with easy access to schools, colleges, market, healthcare centers, commercial-hubs, entertainment and all the essentials, you are WELL CONNECTED.

SCHOOLS  
COLLEGES

HEALTHCARE  
CENTERS

WORK PLACE





# Welcome Yojan One

BKC CROSSING

A landmark that incorporates all that is EXCELLENT IN DESIGN. A well laid out plan, remarkable detailing, grand elevation, each aspect is complimentary to each other. Everything that you have ever imagined for your home, has been incorporated in YOUR HOME at YOJAN ONE.



A woman with long brown hair tied back, wearing a black tank top and black leggings with orange trim, is performing a bicep curl in a gym. She is kneeling on a black exercise bench, holding a black dumbbell with the number '9' on it. Her right arm is extended forward, resting on the bench, while her left arm is bent at the elbow, lifting the dumbbell. The gym background is softly blurred, showing various pieces of equipment and large windows letting in natural light.

# Welcome Freedom

Take time out, AT YOUR OWN TIME.  
With a FULLY LOADED GYMNASIUM,  
make good use of the time and  
leisure at hand. Be at a liberty to  
choose your own path to a HEALTHY  
MIND AND BODY.





The image shows a contemporary living and dining area. On the left, a light-colored sofa is positioned against a wall with two framed artworks. A large window in the center provides a panoramic view of a city and greenery, with an airplane visible in the sky. A modern chandelier hangs from the ceiling. In the foreground, a dining table is set with white plates, a glass, and a vase of flowers. To the right, a kitchen area with white and wood cabinetry is visible. A built-in MANDIR (prayer space) is integrated into the living area, featuring a golden statue on a shelf. The room is illuminated by recessed ceiling lights and a floor lamp.

# Welcome Home

Open the door to magnificence. From the superb finishes, pastel shades, to the panoramic view, everything speaks of grandness. Ever so thoughtfully, the designers have built-in MANDIR spaces in select apartments. Truly an experience that sets the tone for a SUPERIOR LIFESTYLE.





*Welcome*  
**The Inner Chef**

When your home is equipped with a MODULAR KITCHEN, complete with MODERN FIXTURES AND FINISHES, it is sure to inspire the culinary skills in you. Relish many memorable moments and a much deserved FAMILY TIME.





# Welcome Coziness

A comfort area of any home, the BEDROOM is the zone for relaxation, which gets you ready for the day. The built-in wardrobe gives you a clutter free space, for the best layout. The comforting view of the stars makes sure that you get a good night's sleep, and are completely rejuvenated.





# Welcome to **M CLUB**

YOJAN ONE offers not just a sought after location and exclusive homes, but a complete lifestyle. M CLUB, a multi activity hub, with a CLUBHOUSE, GYMNASIUM and a BANQUET HALL spaced around a lush GARDEN. Entertain your friends and guests and relish LIFE.

\*All the amenities shown here are subject to the approval from concern authorities.



\*Artist's impression. Not the actual offering. \*All the amenities are conceptual and subject to the approval of concern authorities.





Along with the M CLUB, you have a beautiful GARDEN, with integrated ACTIVITY SPACES, to experience a WHOLESOME LIFESTYLE.

# Welcome Layout

- |                                       |                          |                                 |
|---------------------------------------|--------------------------|---------------------------------|
| 1. GRAND DOUBLE HEIGHT ENTRANCE LOBBY | 7. COURTYARD             | 13. SENIOR CITIZEN SEATING AREA |
| 2. CLUB HOUSE                         | 8. JOGGING TRACK         | 14. GAZEBO / CABANA             |
| 3. BANQUET HALL WITH KITCHEN          | 9. SEATING AREA          | 15. HERB GARDEN                 |
| 4. LOUNGE                             | 10. CHILDREN'S PLAY AREA | 16. SCENTED FLOWERBED           |
| 5. SOCIETY OFFICE                     | 11. REFLEXOLOGY PATH     | 17. GYMNASIUM ON 1ST FLOOR      |
| 6. CAR WASHING STATION                | 12. LAWN                 |                                 |





# Welcome Amenities

## ■ OUTDOOR RECREATIONAL ACTIVITIES

- Landscaped Garden
- Children play area
- Meditation Deck
- Cabana / Gazebo
- Nana Nani Park
- Jogging Track

## ■ INTERNAL AMENITIES

- Imported Marble flooring in Living & Dining Area & Kitchen
- Quality flooring in Bedrooms
- Security door phones in each Apartment
- Built-in wardrobe space
- Dedicated Mandir Area
- Modular Kitchen with dedicated refrigerator & washing machine area
- Split air conditioners in living & all bedrooms
- Outer safety grill - auto locking sliding safety grill
- Adequate electrical points
- Branded bathroom fitting equivalent to Kohler / Jaguar / Hindware etc.
- Anti-skid flooring in bathroom



## ■ GENERAL AMENITIES

- Automated Mechanical Parking
- 24 X 7 Security Systems with CCTV Surveillance
- Ample Storage for Water Supply (24 X 7)
- Power back-up with Dual Power System for Critical Common Areas & Lifts
- Car Washing Station
- Dedicated Vending Zone

## ■ TOWER AMENITIES

- Earthquake Resistant Building
- Grand Double Height, Air Conditioned, Main Entrance Lobby
- Lounge
- Closed Circuit TV System at the Main Entrance Lobby
- Modern Fire-fighting Systems

## ■ DOORS / WINDOWS

- Color coated Aluminium or Equivalent Sliding Windows
- Auto Locking Sliding Safety Grill in all Windows
- Wooden Door with Wooden Frame.

## ■ CLUBHOUSE

- Fully Equipped Gymnasium
- Indoor Game Room
- Banquet Hall with Kitchen



*Welcome*  
**The cocoon**



**1 BHK**



**2 BHK**



# Welcome Access

YOJAN ONE is literally at the CROSSROADS of LIFE. The BKC, with its office and commercial complexes, International hotels, as also the Diamond Bourse, is in the immediate neighbourhood. With top notch Shopping, Malls, Eateries and Restaurants, Healthcare, Educational and Entertainment facilities within reach, you have LIFE at your fingertips. Commuting is very easy with instant access to TRANSPORTATION FACILITIES, including the TERMINUS FOR BULLET TRAIN.

## ACCESS AND CONNECTIVITY

BKC - 0.6 Km  
 Eastern Express Highway - 4.7 Km  
 Western Express Highway - 4.4 Km  
 SCLR - 1.4 Km  
 Domestic & International Airport - 6.7 Km  
 LBS Road - 0.3 Km  
 Bandra - Worli Sea Link - 6.5 km  
 Metro 2B Station (BKC - MTNL) - 900 Mts  
 Worli - 12 Km  
 Free way - 8.9 Km

## EDUCATIONAL INSTITUTES

American School of Bombay  
 Dhirubhai Ambani International School  
 Orchids the International School  
 Ascends International School  
 Mount Litera School  
 Arya Vidya Mandir  
 Bombay Scottish School  
 Podar international School



## GOURMET AND FINE DINE NEARBY

Hitchki  
 Pizza Express  
 Starbucks  
 Theobroma  
 Smoke House Deli  
 Socials

## HEALTHCARE CENTERS

Asian Heart Hospital  
 Guru Nanak Hospital  
 Lilavati Hospital and Research Institute  
 Bhabha Hospital  
 Kohinoor Hospital  
 Hinduja Hospital

## HOSPITALITY AND ENTERTAINMENT IN THE VICINITY

Trident hotel, Bandra Kurla Complex  
 Hotel Sofitel  
 Grand Hyatt  
 Phoenix Market City  
 Jio Conventional Center  
 Maker Maxity  
 Cinemax  
 R City Mall  
 Nature Park 2.9 km

## UPCOMING INFRASTRUCTURE

Mumbai Metro Line 2  
 Mumbai Metro Line 3  
 Mumbai - Ahmedabad Bullet Train  
 Dharavi to BWSL Road  
 BKC to Kurla Extension  
 Sion Chembur Link Road







# Welcome Location

Site Add : Yojan One, H. P. K. marg, near Equinox Business Park, BKC Crossing, Kurla (W), Mumbai - 400070

## Yojan one

BKC CROSSING

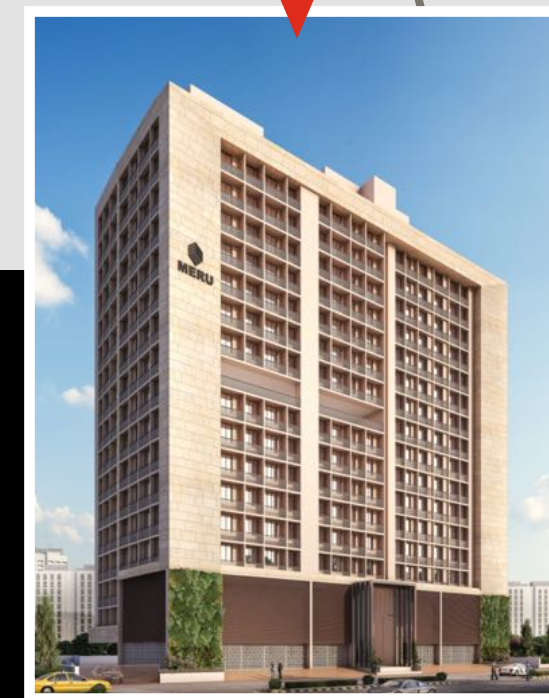





**MERU REALTY**

**HO. :** Meru Realty, G-330, Kanakia Zillion, BKC Annexe,  
L.B.S. Marg, Kurla West, Mumbai - 400 070

**Email :** enquiry@merurealty.in | sales@merurealty.in

**Web :** www.merurealty.in

**Contact :** +91 86863 15555

**Site Address :** Yojan One, H. P. K. marg, near Equinox  
Business Park, BKC Crossing, Kurla West, Mumbai - 400070



**MAHA RERA NO. : P51800028864**

<http://maharera.mahaonline.gov.in>

Architect : **Consultants Combined**

Design Architect : **KSA Architects and Planners Pvt. Ltd.**

RCC Consultants : **Mahimtura and Associates**

SAN GRAPHICS : 9819389437

**Disclaimer :**

The information, layout, pictures etc. shown / contained in this brochure are indicative only. The builder / developer shall not be liable, responsible, obligated and / or required to provide any and / or all such amenities, specification etc. as contained in this brochure. All plans drawings, information, amenities, layout etc. are subject to approval from MCGM and other concerned authorities. The Builder / Developer shall have irrevocable and unconditional right to change, delete, substitute, add, amend etc. the said plans, drawings, information, specification, amenities, layout etc. in such manner as the builder / developer may deem fit. No right of any nature whatsoever shall be construed and / or deemed to have accrued in favour of any person and / or purchaser of the premises from or by virtue of this brochure.



